

VALUE ENGINEERING (PVT) LTD

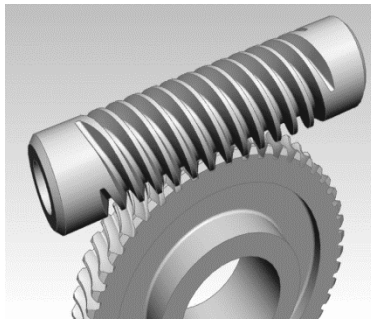

COMPANY PROFILE



Telephones: 04-663664-5
Fax No: 04-664007
Cell phones : 0772 893 895
: 0733 584 315
Email: value.eng@zol.co.zw
info@valueengineering.co.zw

OUR MISSION

To offer comprehensive mechanical engineering solutions to a dynamic industrial market at the most competitive prices.

OUR VISION

To be a leading supplier of world class engineering products and services.

OUR CORPORATE VALUES

Our beliefs and systems are based on the principles of:

- High ethical and moral standards
- Continuous improvement to quality of services/products
- Providing high return on shareholders' equity
- Gainful employment and equal opportunity
- Good corporate citizenship
- Youth empowerment and skills training

GENERAL OVERVIEW

Value Engineering (Private) Ltd was incorporated in 2013, we have since acquired state of the art machinery necessary to enable us to provide complete machining, grinding, gear cutting, maintenance and fabrication services.

HYDRAULICS AND PNEUMATICS REPAIR AND MAINTENANCE SERVICES

Our workshop is fully furnished with a test rig and stripping equipment to cater for all hydraulic requirements - Cylinders, Valves, Pumps and Motors regardless of the size. Having a team of certified technicians and highly experienced machinists, we are proud of our comprehensive and professional services and the supply of filters, hoses and repair kits and new hydraulic components to meet your requirements.

GRINDING SERVICES

Having acquired a 10 tonne capacity Naxos Union Cylindrical Grinder with a swing of 700mm, length of job 4800mm, diameter of job 800mm; being the biggest machine in Zimbabwe, Value Engineering has its pride in handling all types of jobs for grinding and services. This machine is complemented by an experienced operator ensuring all our customers of the best service, best quality and timeous deliveries.

GEAR CUTTING

We have a state of the art Gearhobbing and Bevel Gear Cutting machines, which have confirmed us as one of the leading providers on Gear Cutting services. These machines are complimented by a deliberate skills upgrading exercise which gives us the capacity to take on all and any Gear cutting job in the country.

FABRICATION BAY

We have a spacious and well equipped fabrication bay for the fabrication of chutes off site, conveyer rollers, pulleys and oven spares fabrications.

MACHINING

We have state of the art, Milling and Center Lathe Machines with a bed length capacity of up to 5meters and diameter up to 1,5metre and overhead crane.

SUPPLIES

- As an authorized Distributor for CPM, we boast in the supply of conveyer pulleys and winches for all markets.

REGISTRATION DETAILS

Company Certificate Registration	:	7451/2013
Registered Address	:	14 Hermes, Southerton, Harare
Business Partner Number	:	200134370
Vat Registration Number	:	10062832
N S SA Number	:	S S R 0187223 R
Vendor Number	:	708980
Tax Clearance Certificate (ITF263)	:	31-12-2016
Bankers	:	NMB Southerton Branch
	:	Stanbic Bank Southerton Branch
Public Officer	:	J Dube Cell 0772 893 895
Directors Register	:	J- .Dube Managing Director A Dube Director
Key Personnel	:	Administration A. Dube Production Manager -K Mbidzo 0772 816 559 Sales Engineer- N Mapfoche 0773799160
Payment Terms	:	CASH ACCOUNT / 30 DAY ACCOUNT

PRODUCT PORTFOLIO

We specialize in the following:



1. GEAR CUTTING up to 1000mm Diameter

We cut the following types of gears and sprockets

- Sprockets-Steel and Plastic
- Spur gears
- Helical Gears
- Bevel Gears and Spiral Bevel Gears
- Worm Gears
- All types of nylon gears



2. MACHINING

We do machining of the following:

- Bushes-steel, bronze, cast iron, plastic etc
- Keyways and key cutting, Threading and studding
- Taper locks and tapered shafts
- Shafts up to 5meters long- Pump shafts, roller shafts, rotor shafts, Geared shafts, saw drums, live rollers, etc
- Rubber Roller Grinding and Machining
- Pulleys and Couplings



MATERIAL: Material includes stainless steel, and all steel or any other material as per the customer's specifications.

3. INDUSTRIAL GEARBOXES

- We manufacture and repair gearbox components for the following:
- Radicon, Bauer, Sew Euro drive, Croft and Roxin, Bonfiglioli Gearboxes
- Worm shafts
- Worm Gears and wheels
- Gearbox Housings
- Bearing seats
- Pinion Gears/ shafts
- Gear reduction adjustments



4. PLANT MAINTENANCE AND SERVICE

- We specialize in repair and services to industrial winches
- We specialize in pulley rehabilitations
- We repair and service industrial valves-Gate Valves, Boiler valves, Steam valves Plugvalves, Ball valves, Air valves, non-return valves etc. All valves are pressure tested.
- We repair and service all types of water pumps and sewer pumps- Centrifugal, multistage, slurry etc.
- Plant servicing and maintenance
- Artisan hire for servicing of industrial plants



5. PUMPS, VALVES AND PIPE ACCESSORIES SUPPLIES - all materials

- Pumps all types
- Pressure Relief Valves
- Gate valves from 50mm-200mm
- Fire hydrant valves- 50mm-75mm
- Taper plug valves- 50mm-150mm
- Air release valves- 40mm-75mm
- Ball valves/ float type valves
- Pipe saddles and Cast iron pulleys



6. ENGINEERING PLASTICS- NYLON AND VESCONITE PRODUCTS

- Plastic rollers
- Plastic sprockets
- Plastic gears
- Plastic chain guides
- Plastic guides and slide rails
- Bushes

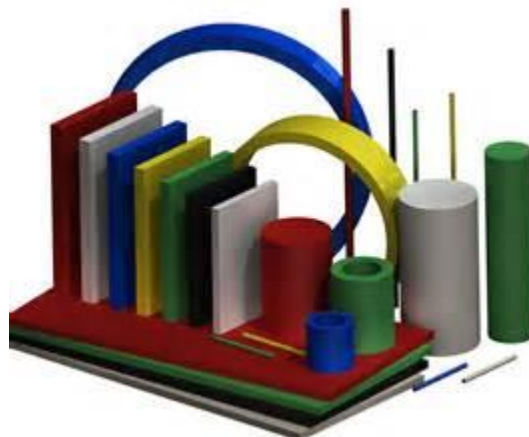

7. CONVEYERS AND CONVEYER ACCESSORIES

- Steel Rollers- Idlers, Troughing and Return Rollers
- Impact Rollers
- Conveyor rollers and pulleys
- Conveyor drums
- Pressure tanks and Flanged pipes
- Airline filters and fans
- Rubberized/plastic rollers
- Printing rollers
- Rubberizing Rollers

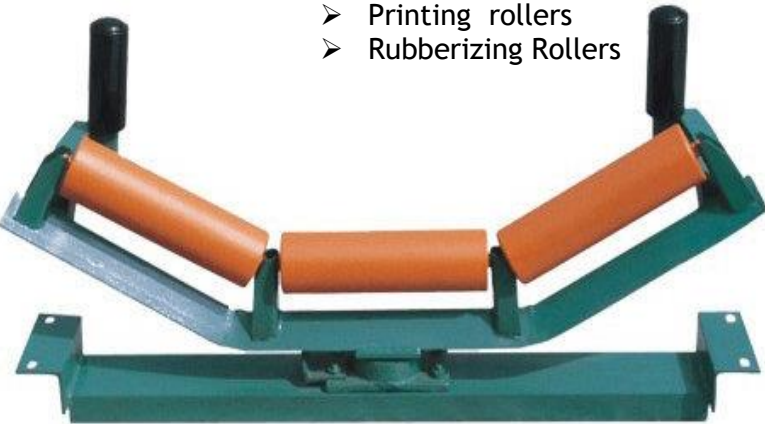

8. LABOUR OUTSOURCING

Value Engineering specializes in artisan Hire for servicing industrial plants and mines

Contracted at Zimbabwe Platinum Mines in the following areas

- Chute fabrication, assembly and test run at OPEN PIT CRUSHER.
- Mark out and cut liners, fabricate chutes and apron feeder complete with assembly and test run at PORTAL TWO.
- Plant Maintenance at PORTAL TWO AND PORTAL 1.

9. MINING PLANT SPARES AND PRODUCTS

- Woven brake linings
- Rail Brake Blocks
- Mine winders and Mine hoists
- Scraper winches
- Underground locomotive spares
- Shunting Locomotives
- Dolly Wheels and Pulleys
- Compressor Halves
- Mobile Cranes
- Locomotive Wheel Axle Assemblies - all types
- Vesconite and Vescolene Ultra Black material
- Hydraulic Units Repairs- Hydraulic Pumps, Hydraulic Motors, Hydraulic Valves etc
- White Metal Bearing Casting and Machining,
- Pneumatic Valves - HD 2FX Control air Valves
- Cooper Bearings

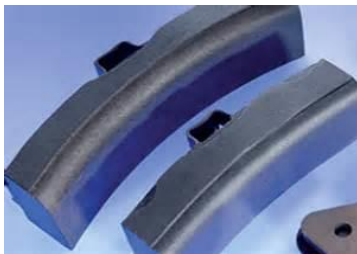

10. CYLINDRICAL GRINDING SERVICES

We are proud to offer cylindrical grinding services in all materials ie steel, rubber etc in the following capacities

- 10 tonne capacity
- swing of 700mm,
- length of job 4800mm,
- diameter of job 800mm



TRADE REFERENCES

The Company has established solid and progressive business relationships with leading manufacturing organizations, which include the following:

COMPANY	Contact Person	Contact Tel
➤ Zimplats	Mr Offman	0772 943 165
➤ Samrec Vermiculite	Mr Marowa	0773 455 271
➤ Sino-Zimbabwe Cement	Mr Tirivanhu	0772 719 446
➤ Bikita Minerals	Mr K Mlilo	0783 279 546
➤ Bindura Nickel	Mr Hompa	0774 605 815
➤ Lobels Bread	Mr Muvhawa	0774 629 770
➤ Lafarge Cement	Mr Tawonameso	0774 555 371
➤ Z F C	Mr Katsande	0773 226 230
➤ Hunyani Flexible Packaging	Mr. Chaleka	0775348487
➤ Hunyani corrugated products	Mr Shumba	0772 326 798
➤ Freda Rebecca	Mr. Panosvisva	0771 337 070
➤ ZPC Harare Power Station	Mr. Jenami	0772 810 767
➤ ZPC Hwange Power Station	Mr Kapeto	0773 930 531
➤ Waverly Blankets	Mr. Shabbir	0772 244 741
➤ Irvine's Zimbabwe	Mr. G Howard	0772 256 346
➤ NatPak	Mr Taruvinga	04-749463
➤ Manyame Milling	Mr Mahanyama	0712 343 272
➤ MD de Chassart & Sons (Surrey)	Mr Thomas	0773 287 787